

PULL STUDS FOR BT, TC TAPERS

PULL STUDS FOR BT TAPER SHANK TOOLS

DIMENSIONS IN mm

DESIGNATION	D1	D2	D3	D4	D5	L1	L2	L3	θ	FIG
PS/CST1/30/30/01	M12	12.5	16.5	7	11	43	23	18	30	1
PS/CST1/30/45/02	M12	12.5	16.5	7	11	43	23	18	45	1
PS/CST1/30/0/03	M12	12.5	16.5	7	11	43	23	18	0	1
PS/CST1/40/30/06	M16	17	23	10	15	60	35	28	30	1
PS/CST1/40/30/06/C	M16	17	23	10	15	60	35	28	30	2
PS/CST1/40/45/07	M16	17	23	10	15	60	35	28	45	1
PS/CST1/40/45/07/C	M16	17	23	10	15	60	35	28	45	2
PS/CST1/40/45/08	M16	17	23	11.3	15.5	57	35	26	45	1
PS/CST1/40/0/09	M16	17	23	10	15	60	35	28	0	1
PS/CST1/40/0/10	M16	17	23	10	15	50	29	18	0	1
PS/CST1/40/15/11	M16	17	23	14	19	54	29	23	15	1
PS/CST1/40/15/11/C	M16	17	23	14	19	54	29	23	15	2
PS/CST1/40/15/11/C0	M16	17	23	14	19	54	29	23	15	3
PS/CST1/45/30/12	M20	21	31	14	19	70	40	31	30	1
PS/CST1/45/45/13	M20	21	31	14	19	70	40	31	45	1
PS/CST1/50/30/14	M24	25	38	17	23	85	45	35	30	1
PS/CST1/50/30/14/C	M24	25	38	17	23	85	45	35	30	2
PS/CST1/45/0/15	M20	21	31	14	19	70	40	31	0	1
PS/CST1/50/45/16	M24	25	38	17	23	85	45	35	45	1
PS/CST1/50/45/16/C	M24	25	38	17	23	85	45	35	45	2
PS/CST1/50/0/17	M24	25	38	17	23	85	45	35	0	1

PULL STUDS-DIN69872

PS/CST2/40/15/01	M16	17	23	14	19	54	26	20	15	5
PS/CST2/40/15/01/C	M16	17	23	14	19	54	26	20	15	4
PS/CST2/30/15/02	M12	13	17	9	13	44	24	19	15	5
PS/CST2/45/15/04/C	M20	21	30	17	23	65	30	23	15	4
PS/CST2/50/15/05	M24	25	36	21	28	74	34	25	15	5
PS/CST2/50/15/05/C	M24	25	36	21	28	74	34	25	15	4

PULL STUDS-ISO11173 TYPE 2 & ISO 7388

PS/CST3/40/45/01	M16	17	22.5	12.95	18.95	44.5	16.4	11.15	45	7
PS/CST3/40/45/01/C	M16	17	22.5	12.95	18.95	44.5	16.4	11.15	45	6
PS/CST3/45/45/02/C	M20	21	30	16.3	24.05	56.0	20.95	14.85	45	6
PS/CST3/50/45/03	M24	25	37	19.6	29.10	60.05	25.55	17.95	45	7
PS/CST3/50/45/03/C	M24	25	37	19.6	29.10	60.05	25.55	17.95	45	6

NEED A SPECIAL PULL STUD

Just call or fax, we will assist you in selecting the proper pull stud

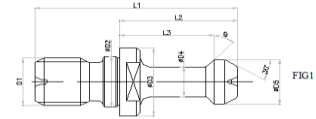

For assistance, provide the following information

Quantity _____

Dimension ØD5 _____ in / mm

Dimension ØD4 _____ in / mm

Dimension ØD2 _____ in / mm

Dimension L2 _____ in / mm

Dimension L3 _____ in / mm

Angle degrees _____ degrees

Thread Size (D1) _____

Tool holder _____

Shank Type _____

Machine _____

Make _____

Machine _____

Model _____

Coolant Hole Yes/No _____

Coolant Hole _____

Diameter _____ in / mm

O-Ring Required Yes/No _____

Send sketch of O-Ring _____

Position _____

At end of Part No.....

C – Indicates Coolant hole.

O – Indicates with O-Ring.

NOTE:

- OTHER TYPES OF PULLSTUDS CAN BE SUPPLIED ON REQUEST

ORDERING INSTRUCTION

PS / CST1 / 40 / 45 / 07 / C

PULL STUD TYPE	SL. NO	WITH COOLANT HOLE
TAPER		GRIPPER ANGLE