

Fig - 1

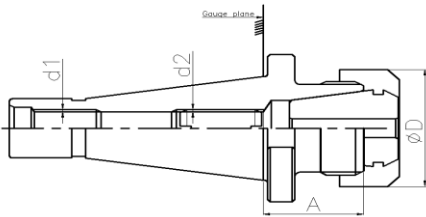
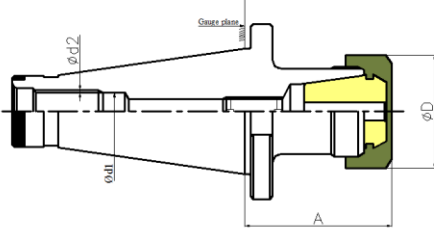

Fig - 2



 DIMENSIONS IN mm

DESIGNATION	SUITABLE FOR COLLET	COLLET CLAMPING CAPACITY (MM)	A	ød1	STOPPER SCREW ød2	NUT		SPANNER DESIGNATION	FIG.
						øD	DESIGNATION		
ISO 30/ER32/50	ER32	3-20	50	M12	M16	50	UM/ER32	E32	1
ISO 30/ER40/70	ER40	4-26	70	M12	M16	63	UM/ER40	E40	1
ISO 40/ER16/50	ER16	1-10	50	M16	M8	28	UM/ER16	GS25	2
ISO 40/ER20/50	ER20	2-13	50	M16	M10	34	UM/ER20	GS30	2
ISO 40/ER25/50	ER25	2-16	50	M16	M12	42	UM/ER25	E25	2
ISO 40/ER32/50	ER32	3-20	50	M16	M16	50	UM/ER32	E32	2
ISO 40/ER40/50	ER40	4-26	50	M16	M16	63	UM/ER40	E40	2
ISO 40/ERO25/50	ERO25	2-16	50	M16	M12	43	UM/ERO25	E25	2
ISO 40/ER032/50	ER032	2-25	60	M16	M16	60	UM/ERO32	E40	2
ISO 40/ER044/65	ER044	4-32	65	M16	M16	72	UM/ERO44	E50	2
ISO 50/ER40/60	ER40	4-26	60	M24	M16	63	UM/ER40	E40	1
ISO 30/ER50/65	ER50	12-34	65	M24	M16	78	UM/ER50	E50	1

NOTE:

- COLLET CHUCKS ARE SUPPLIED WITH NUTS
- RD COLLETS ARE SAME AS ER COLLETS CONFORMING TO DIN 6499 FORM B.
- **PLACE SEPARATE ORDER FOR SPANNERS. (Refer page No. 59)**

ORDERING INSTRUCTION

